

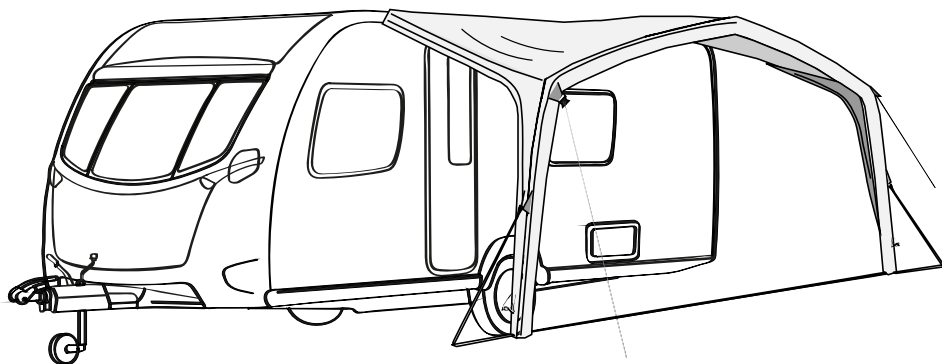

TENTS AND EQUIPMENT

SUNSHINE AIR



Sunshine AIR Tour

EN	Awning tent Installation and Operating Manual.....	9
DE	Vorzelt Montage- und Bedienungsanleitung.....	14
FR	Auvent Instructions de montage et de service.....	20
ES	Avancé Instrucciones de montaje y de uso.....	26
PT	Avançado Instruções de montagem e manual de instruções.....	32
IT	Veranda Istruzioni di montaggio e d'uso.....	38
NL	Voortent Montagehandleiding en gebruiksaanwijzing.....	44
DA	Fortelt Monterings- og betjeningsvejledning.....	50
SV	Förtält Monterings- och bruksanvisning.....	56
NO	Fortelt Monterings- og bruksanvisning.....	61
FI	Etuteltta Asennus- ja käyttöohje.....	67
PL	Przedsiónek Instrukcja montażu i obsługi.....	72
SK	Pristrešok Návod na montáž a uvedenie do prevádzky.....	78
CS	Předstan Návod k montáži a obsluze.....	84
HU	Előszátor Szerelési és használati útmutató.....	90

Copyright

© 2024 Dometic Group. The visual appearance of the contents of this manual is protected by copyright and design law. The underlying technical design and the products contained herein may be protected by design, patent or pending patent. The trademarks mentioned in this manual belong to Dometic Sweden AB. All rights are reserved.

List of Figures

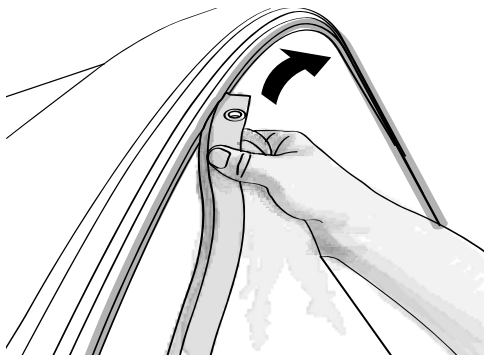
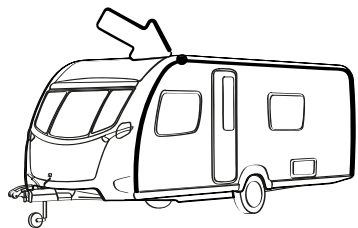
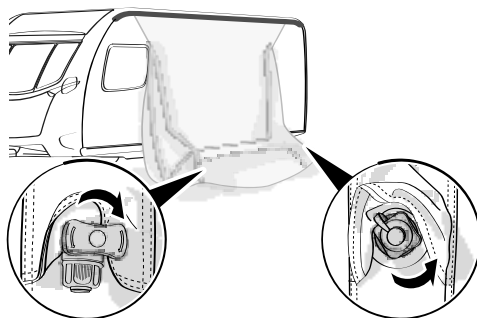
1**2**

3



9 PSI / 0.62 bar

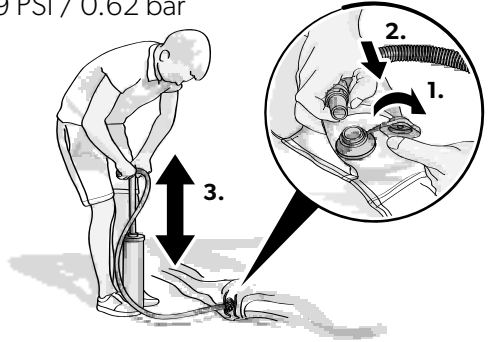

4

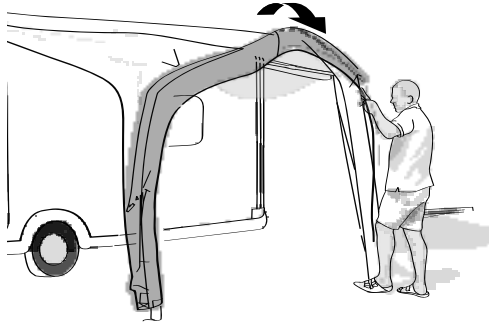

5

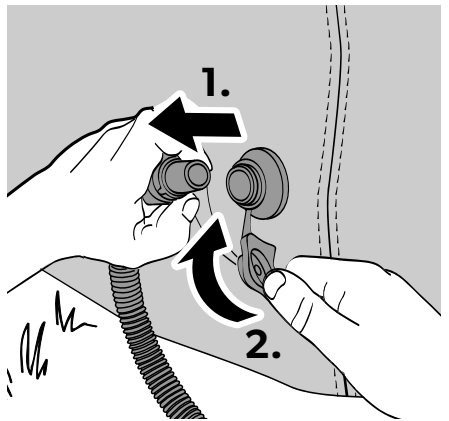

6

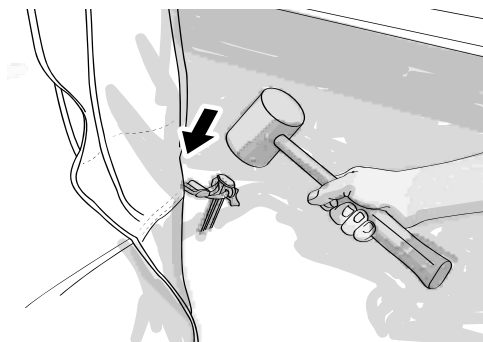
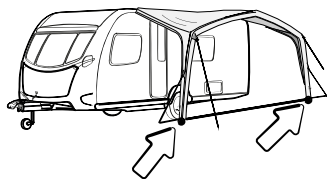

7

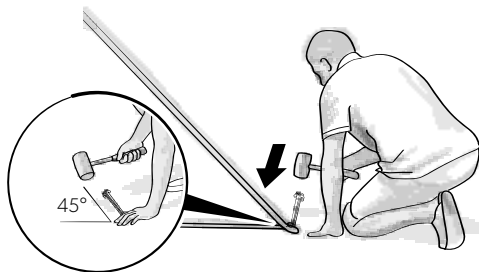

8

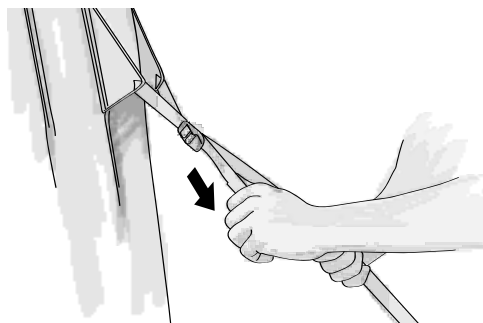

9

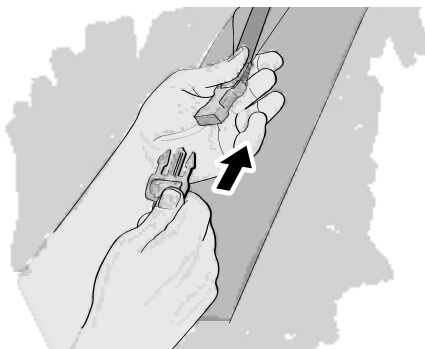

10

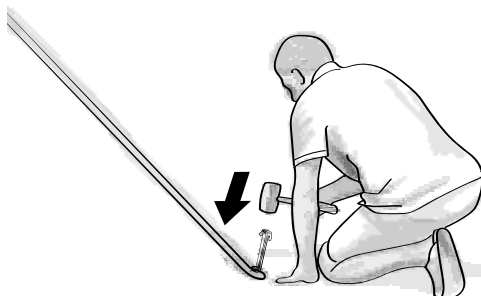

11

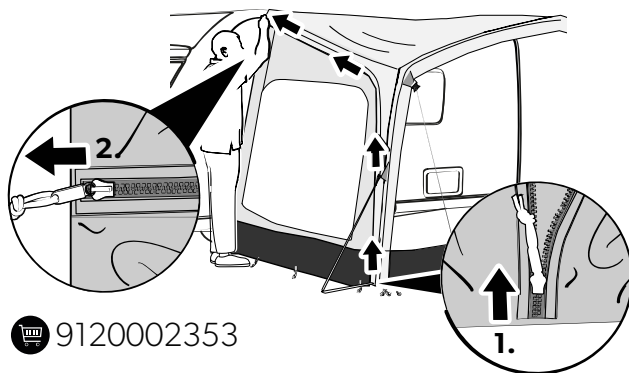

 9120002353

12

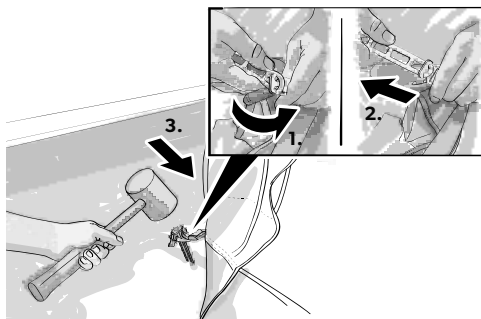

13

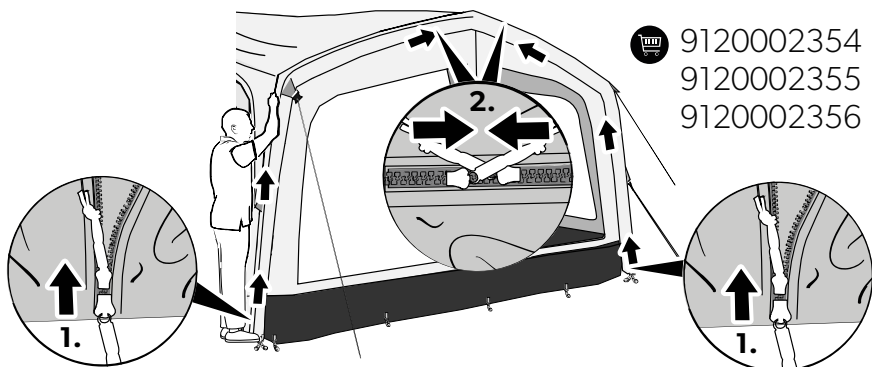

14

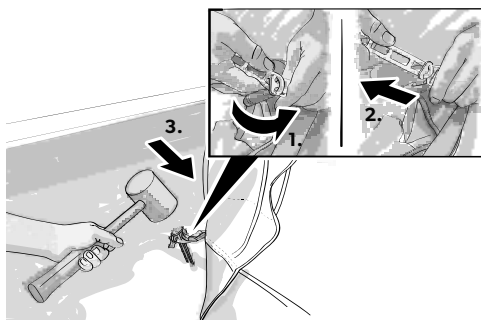

15

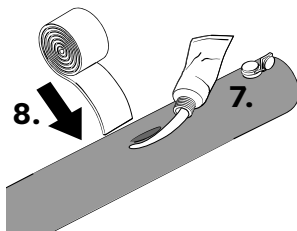
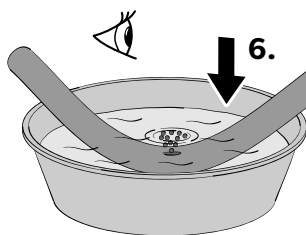
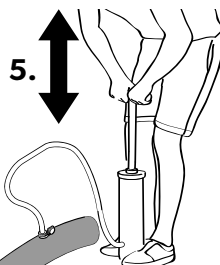
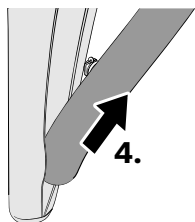
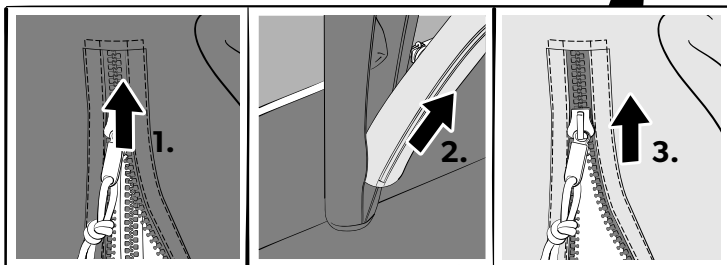
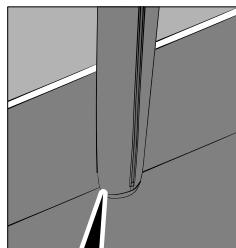
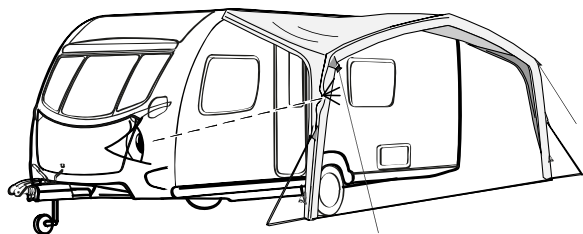

English

1	Important notes.....	9
2	Explanation of symbols.....	9
3	Safety instructions.....	9
4	Scope of delivery.....	9
5	Accessories.....	10
6	Intended use.....	10
7	Using the awning tent.....	10
8	Cleaning and maintenance.....	12
9	Troubleshooting.....	12
10	Disposal.....	13
11	Warranty.....	13

1 Important notes

Please read these instructions carefully and follow all instructions, guidelines, and warnings included in this product manual in order to ensure that you install, use, and maintain the product properly at all times. These instructions **MUST** stay with this product.

By using the product, you hereby confirm that you have read all instructions, guidelines, and warnings carefully and that you understand and agree to abide by the terms and conditions as set forth herein. You agree to use this product only for the intended purpose and application and in accordance with the instructions, guidelines, and warnings as set forth in this product manual as well as in accordance with all applicable laws and regulations. A failure to read and follow the instructions and warnings set forth herein may result in an injury to yourself and others, damage to your product or damage to other property in the vicinity. This product manual, including the instructions, guidelines, and warnings, and related documentation, may be subject to changes and updates. For up-to-date product information, please visit documents.dometic.com.

2 Explanation of symbols

A signal word will identify safety messages and property damage messages, and also will indicate the degree or level of hazard seriousness.



DANGER!

Indicates a hazardous situation that, if not avoided, will result in death or serious injury.



WARNING!

Indicates a hazardous situation that, if not avoided, could result in death or serious injury.



CAUTION!

Indicates a hazardous situation that, if not avoided, could result in minor or moderate injury.



NOTICE!

Indicates a situation that, if not avoided, can result in property damage.



NOTE Supplementary information for operating the product.

3 Safety instructions



DANGER! Hazard of carbon monoxide poisoning.

Never use a fuel-burning appliance such as barbecues or gas heaters inside. The burning process produces carbon monoxide which accumulates inside as there is no flue.



WARNING! Fire hazard

- > KEEP ALL FLAME AND HEAT SOURCES AWAY FROM THE FABRIC.
- > Ensure you know the fire precaution arrangements on the site.
- > Do not cook inside or use open flames.



WARNING! Beware of suffocation

Ensure ventilation openings are open all the time to avoid suffocation.



CAUTION! Risk of injury.

- > This device is not intended for use by persons (including children) with reduced physical, sensory or mental capabilities, or lack of experience and knowledge, unless they have been given supervision or instruction concerning use of the device by a person responsible for their safety.
- > Do not allow children to play around and ensure that suitable protective footwear is worn. Guy lines are a trip hazard and pegs can be sharp.
- > Cleaning and user maintenance shall not be made by children without supervision.
- > Keep passage ways clear.

4 Scope of delivery

Component	Quantity
Awning tent	1
Hand pump	1
Storm tie down kit mist	2

Component	Quantity
Peg set	1
Transportation bag	1
Installation and operating manual	1

5 Accessories

Available as accessories (not included in the scope of delivery):

Description	Ref. No.
Front panel	
Size 300	9120002354
Size 400	9120002355
Size 500	9120002356
Side panel	9120002353

6 Intended use

This awning tent is suitable for the following applications:

- Motorhomes and caravans
- Light to moderate weather
- Touring

This awning tent is not suitable for the following applications:

- Very strong winds or snowfall
- Seasonal pitch or commercial use

This product is only suitable for the intended purpose and application in accordance with these instructions.

This manual provides information that is necessary for proper installation and/or operation of the product. Poor installation and/or improper operating or maintenance will result in unsatisfactory performance and a possible failure.

The manufacturer accepts no liability for any injury or damage to the product resulting from:

- Incorrect installation or assembly
- Incorrect maintenance or use of spare parts other than original spare parts provided by the manufacturer
- Alterations to the product without express permission from the manufacturer

- Use for purposes other than those described in this manual

Dometic reserves the right to change product appearance and product specifications.

7 Using the awning tent



CAUTION! Risk of injury and material damage

Never open the zipper on the protective sleeve while an air pole is inflated. This will result in the air pole bursting.

7.1 Before first use

Before using the product for the first time, perform a test set-up to familiarize yourself with it. Check if the scope of delivery is complete.

7.2 Choosing a site

Choose a flat site that is protected from wind:

1. If necessary, use a windbreak.
2. Choose a shaded site to reduce UV degradation of the fabric.
3. Do not pitch under trees as falling branches, resin, or other debris can damage the product.
4. Clear the site of sharp stones and debris to protect the groundsheet.
5. Set up the product with the doors facing away from the wind.

7.3 Setting up the awning tent



CAUTION! Risk of injury and material damage

- > Do not use any type of compressor designed to inflate car tires.
- > Only inflate the air poles under control of a pressure gauge with a pressure of 9 psi (0.62 bar).



NOTICE! Material damage

- > Do not open or close the zippers by force.
- > If a wind-out awning is used to attach the awning tent, support the wind-out awning while working to avoid putting too much stress on it. After attaching the awning tent, rewind the wind-out awning fully back into its housing. This product should not be used with the cassette awning in its extended position.



NOTE

- The supplied pegs are heavy duty pegs. They will be suitable for most sites, but special pegs may be required for certain ground types. Ask your dealer.
- Drive the pegs at a 45° angle away into the ground.
- Peg the guy lines in line with the seam it starts from.

Keep the following tips in mind while setting up the awning tent:

- The figures provide a general overview of the set-up. The actual set-up will vary slightly based on the model of awning tent.
- Get help. The set-up is easier with more people.
- After standing the awning tent upright, check the corner pegs and re-peg if necessary. The groundsheet on the inside should be taut and in a rectangular shape.
- Peg the guy lines so that the awning tent is under tension without distorting the shape.
- If available, attach the storm tie down kit.
- Regularly check the guy lines to ensure adequate tension. If necessary, use the runners to adjust.

Set up the awning tent as follows:

1. Unpack the awning tent:
 - a) To protect the awning tent from dirt and damage, lay down a groundsheet or footprint before unpacking.
 - b) Unpack the awning tent.
 - c) Separate and identify the different components.
2. Insert the keder into the rail and pull the awning tent through to the desired location.

 **Fig. 1 on page 3**
3. Inflate the awning tent:

- a) Close the deflation valve at the front of the awning tent and unscrew the top cap of the inflation valve.

 **Fig. 2 on page 3**
- b) Insert the pump and inflate to between 3 psi and 4 psi initially.

 **Fig. 3 on page 4**
- c) Lift the awning tent from either end to help it take shape.

 **Fig. 4 on page 4**
- d) Continue inflating to 9 psi.
- e) Remove the pump and secure the top cap of the inflation valve.

 **Fig. 5 on page 4**
4. Secure the awning tent:
 - a) Peg the front two corners using the adjustable straps.

 **Fig. 6 on page 5**
 - b) Peg out the quick pitch guy lines.

 **Fig. 7 on page 5**
 - c) Tighten the quick pitch guy lines once in position.

 **Fig. 8 on page 5**
 - d) Attach and peg the storm tie down kit.

 **Fig. 9 on page 6**

 **Fig. 10 on page 6**
5. (Optional) Set up the side panels:
 - a) Zip the side panel into the side of the awning tent.

 **Fig. 11 on page 6**
 - b) Attach the ladder straps to the pegging points at the bottom of the side panel.

 **Fig. 12 on page 7**
 - c) Secure the side panel by pegging the rear pegging points slightly underneath your vehicle.
 - d) Peg the remaining pegging points along the bottom of the side panel. Ensure that the side panel is taut but not overly stretched.
6. (Optional) Set up the front panel:
 - a) Zip the front panel into the front of the awning tent.

 **Fig. 13 on page 7**
 - b) Attach the ladder straps to the pegging points at the bottom of the front panel.

 **Fig. 14** on page 7

- c) Peg the front panel.

7.4 Dismantling the awning tent



NOTICE! Damage hazard

Do not use force when dismantling the awning tent. Otherwise you might damage any material.

1. Remove any dirt on the outside.
2. Close all doors and openings.
3. Remove all lines and straps.
4. Remove all pegs between the corner pegs.
5. Open the valves on each pole.
6. Wait until most of the air has been expelled.
7. Remove the four corner pegs.
8. Fold/roll the awning tent towards the valves to expel more air.
9. When deflated, roll the awning tent to fit into the transportation bag.
10. Ensure that all parts are clean before packing them into the transportation bag.
11. If the awning tent is wet or damp, dry fully as soon as possible.

8 Cleaning and maintenance



NOTICE! Material damage

- > Do not use sharp or hard objects or cleaning agents for cleaning.
- > Do not use alcohol based materials, chemicals, soap and detergents for cleaning.
- > Remove bird droppings and tree resin as soon as possible to avoid permanent damage to the material.

1. If necessary, clean the product with clean water and a soft brush.
2. Apply impregnation against water and UV radiation before each trip.

8.1 Storing the awning tent



CAUTION! Health hazard and material damage

A wet or damp awning tent will quickly develop mold. Mold can also develop if the awning tent is left up for long periods of time with poor ventilation.

- > Fully set up the awning tent for cleaning.
- > Choose a warm and sunny day for cleaning to ensure the material will dry thoroughly.

1. Clean the awning tent.
2. Fully air out the awning tent and ensure it is totally dry before packing away.
3. Store in a well ventilated, dry place, away from direct sunlight.

9 Troubleshooting



NOTE

During first exposure to water there may be some moisture at the seams. Through this moisture the threads will swell and fill the holes that are created in the sewing process.

A fully equipped spare parts kit should include:

- Waterproofer
- Repair tape and repair solution
- Silicone spray for the zippers
- Spare pegs

All these spare parts can be purchased from any reputable caravan or camping dealer.

Problem	Suggested remedy
Awning tent inflates with difficulties	<ul style="list-style-type: none"> > Check that the valve is fully screwed into the air pole. > Check if the inflation tube is twisted at the valve. This may be indicated by noise. Untwist the inflation tube. > Check that the hand pump is working.

Problem	Suggested remedy
Part of the awning tent does not inflate or deflate	> Check that all isolation valves that connect the air poles are open.
Air poles are kinked	> Add more air (9 psi /0.62 bar).
Air leak	> Check that the valve is fully screwed into the air pole and the ring seal is in place. > Check that the cap of the valve is done up tightly. > Check for punctures, see Repairing a puncture in the air pole on page 13.
Water leak	> Check for leaky seams, damaged tapings, and moist areas.
	> If you cannot find any leaks, see Condensation on page 13. > If you find any leaks, apply seam sealant.
Rip in the fabric	> Use repair tape to seal the fabric.
	> Have repairs carried out by an authorized specialist.

9.1 Condensation

The product suffers from internal condensation if one or more of the following conditions apply:

- High air humidity
- High ground moisture
- A drop in temperature

Severe condensation can run down the inside of the roof and drip off ties, tapes and other internal fittings and can be mistaken for leaking.

- > Increase ventilation by opening doors and/or windows.
- > Ensure that the material is not permanently damp. If necessary, dry it completely to avoid mold growth.
- > Install a waterproof groundsheet.

9.2 Repairing a puncture in the air pole

If the air pole loses air, proceed as follows:

1. Unzip the outer sleeve holding the air pole.
2. If installed, close isolation valves.
3. Remove the air pole.
4. Deflate the air pole.
5. Unzip the protective sleeve to expose the inflatable tube.
6. Blow some air into the inflatable tube.
7. Submerge the tube in water.
8. Locate the puncture.
9. Use repair tape and repair solution to seal the hole.
10. Zip the inflatable tube back into the protective sleeve.
11. Zip the air pole back into the outer sleeve.

 **Fig. 16** on page 8

10 Disposal



Place the packaging material in the appropriate recycling waste bins, wherever possible. Consult a local recycling center or specialist dealer for details about how to dispose of the product in accordance with the applicable disposal regulations.

11 Warranty

The statutory warranty period applies. If the product is defective, please contact the manufacturer's branch in your country (see dometic.com/dealer) or your retailer.

For repair and warranty processing, please include the following documents when you send in the device:

- A copy of the receipt with purchasing date
- A reason for the claim or description of the fault

Note that self-repair or nonprofessional repair can have safety consequences and might void the warranty.

The warranty covers manufacturing defects, materials and parts. The warranty does not cover fading of the cover and wear and tear due to UV radiation, misuse, accidental damage, storm damage, or permanent, semi-permanent or commercial use. It does not cover any resulting damage. Please contact your dealer for claims. This does not affect your statutory rights.