



B2590/65 & B2590/85 Crank Up

Installation & operating instructions

UK contact:

Helpline: +44 (0)1553 811000
Email: support@maxview.co.uk
Web: www.maxview.co.uk

Contents:

Introduction	2	Installing cables	8
Proper use & operation	2	Installing Handle	9
Safety precautions	3	Attaching Satellite Dish to Unit	12
Application example	4	Finding a satellite	13
Product contents	4	Start a search	13
Required tools and equipment	4	Lowering antenna	15
Selecting an installation location	5	Skew adjustment	16
Attaching Antenna Mount Plate and LNB Park Plate	6	Warranty	17
Attaching Antenna Unit to Mount Plate	7	Specifications	18
		Quick reference table	19
		Satellite Zone Map	20

Introduction:

Please read these instructions fully before using the antenna for the first time. The operation of the antenna has been designed to be as simple as possible however should you require any technical assistance please contact Maxview customer service on +44 (0)1553 811000 or visit www.maxview.co.uk.

Proper use & operation:

The Crank Up is designed to be installed in a motorhome, caravan or horsebox to automatically locate a television broadcast satellite when the vehicle is stationary.

The Antenna which is to be permanently mounted externally to the roof structure of a motorhome/caravan horsebox. The construction of the roof structure should be suitably robust and have no protruding obstacles

Use of the equipment for any other purpose than the one specified is not permitted and will invalidate the warranty.

All instructions and models are subject to change. In accordance with policy of progressive product, the company reserve the right to alter specifications.

Copyright© these instructions are the sole property of Maxview Ltd and may not be reproduced. Please keep these instructions safe for future reference.

Recycle packaging where facilities exist.

Safety precautions:

Read this manual carefully and become familiar with your satellite antenna. Understand its applications, its limitations and any hazards involved. Failure to follow all instructions listed below may result in electric shock, fire and/or serious injury. Maxview declines all responsibility in the event of incident or accident if they are due to a non observation of the installation instructions or the way the product is used.

No modifications are permissible to the Antenna Unit or Handle Assembly

Installation

- Installation should be carried out by a competent person.
- Take care when working at heights keeping work area clean and tidy to avoid trip hazards
- Use creeper boards where necessary to ensure roof construction can support your weight
- Use a recommended adhesive from page 4 to bond the antenna unit to vehicle roof and follow the manufacturer's instructions during application
- Do not travel until adhesive has cured noting that curing times vary with weather conditions
- Power tools should be used in accordance with manufacturer's instructions
- All electrical work should be carried out by a competent person. If in doubt seek advice from a qualified electrician

Operation

- Before starting your journey check that antenna is in the park position
- The maximum speed of vehicle with antenna mounted on roof is 81mph (130km/h)
- Never operate the antenna if someone is in close proximity of the antenna
- If high winds or electrical storms are anticipated lower antenna to park position
- Do not allow children to operate the antenna unit
- Do not operate the Crank Up with snow or ice on the antenna

Servicing

- If in the event that you do experience a problem with the system call Maxview Customer Service +44 (0)1553 811000
- Any inspection or repair must be carried out by Maxview or an appointed representative of the manufacturer
- No regular maintenance required on the system
- Do not remove cover on Antenna
- Do not use solvent or abrasive cleaning agents on the system
- Use a suitable mild detergent to clean the Antenna Unit
- Do not pressure wash the Antenna Unit
- Check the Antenna Unit fixings for mechanical integrity at least once a year

Application example:



Product contents:

- > Antenna Unit
- > Handle Assembly
- > 65/85cm Antenna (separate carton)
- > Accessory Pack
 - > LNB Park Plate x 1
 - > No.10 Screws for plastic (small) x 10
 - > M4 Screws for Plastic x 5
 - > Cable Clips x 12
 - > M6 Button Head Screw x 4
 - > M6 Locking Nut x 4
 - > 6mm Plastic Washer x 4
 - > Aluminium 20mm Tube x 1
 - > Steel 4mm Spindle x 1
 - > Self Adhesive Zone Map x 1
 - > Compass x 1
 - > M5 Washers x 2

Required tools and equipment (not supplied):

- > 32mm hole saw
 - > 2.5mm and 8mm twist drill
 - > Power Drill
 - > Hacksaw
 - > No.2 Phillips screwdriver
 - > Weather Resistant Elastic Adhesive* and Applicator gun
 - > Surface Cleaner
 - > 10mm spanner
 - > Hexagonal socket key 4mm
 - > Deburrer/Round File/Emery paper
 - > Conduit (recommend method for securing cables)
- *Maxview recommends the following adhesives:
- > Sikaflex®-512 Caravan
 - > Geocel® Geobond HM
 - > Sikaflex®-252

Selecting an installation location:

Positioning the Antenna Unit and the Handle Assembly

Decide where you wish to mount your satellite system, taking into account obstacles both on the roof and inside the vehicle. The system **MUST** be pointing towards the rear of the vehicle

- > Check for obstructions such as roof lights and vents.
- > Check for electrical cables beneath screw fixing points.
- > Check the 'F' cables will reach satellite receiver (Maxview can supply extended cables).
- > Do not allow the dish to overhang the edge of the vehicle
- > Clearance around antenna system when in use is shown with reference I
- > Ensure adequate clearance of the handle assembly from cupboard doors and light fittings

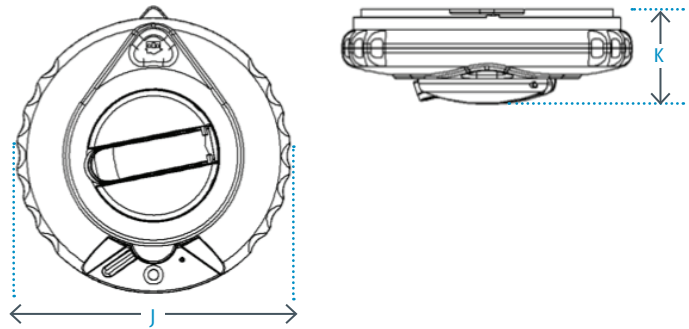
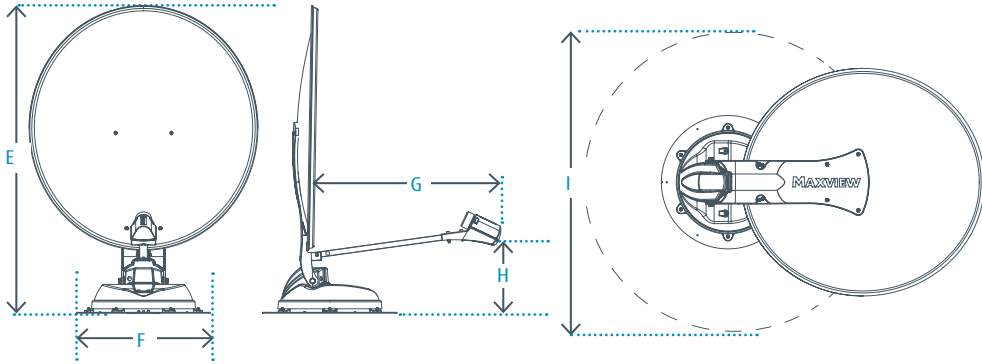
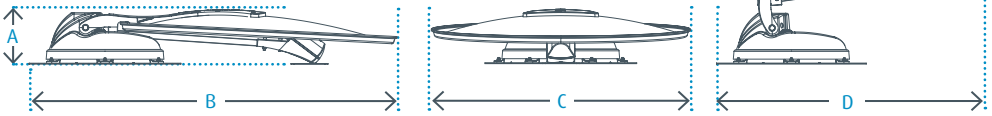
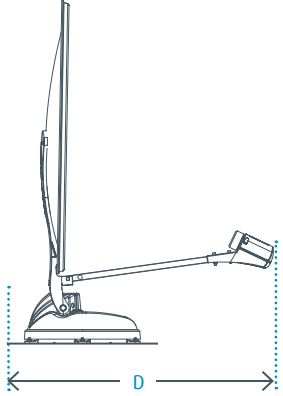

Key dimensions (cm) and weights

65cm Crank Up: System weight 10kg				85cm Crank Up: System weight 11kg			
A: 17	D: 65	G: 52	J: 16	A: 17	D: 87	G: 64	J: 16
B: 100	E: 96	H: 15	K: 5	B: 117	E: 113	H: 14	K: 5
C: 67	F: $\varnothing 43^*$	I: 110		C: 85	F: $\varnothing 43^*$	I: 125	

Attaching Antenna Mount Plate & LNB Park Plate:

1. Remove antenna unit from wooden transit packaging
2. Remove mounting plate from Antenna Unit by removing 6 x M6 nuts using 10mm spanner
3. Clean roof, Mounting Plate and LNB Park Plate in accordance with adhesive manufacturer's guidelines
4. Mark a centre line for the antenna making sure dish will not overhang vehicle
5. Align notches on plate with centre line
6. Mark the position of 6 screw fixing holes and centre hole
7. Mark position of LNB Park Plate

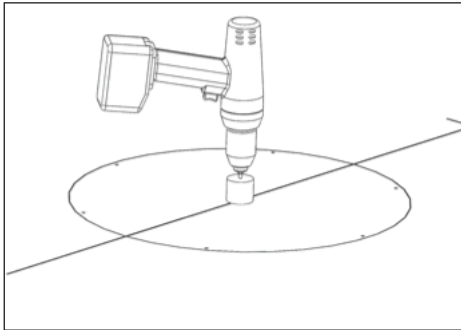
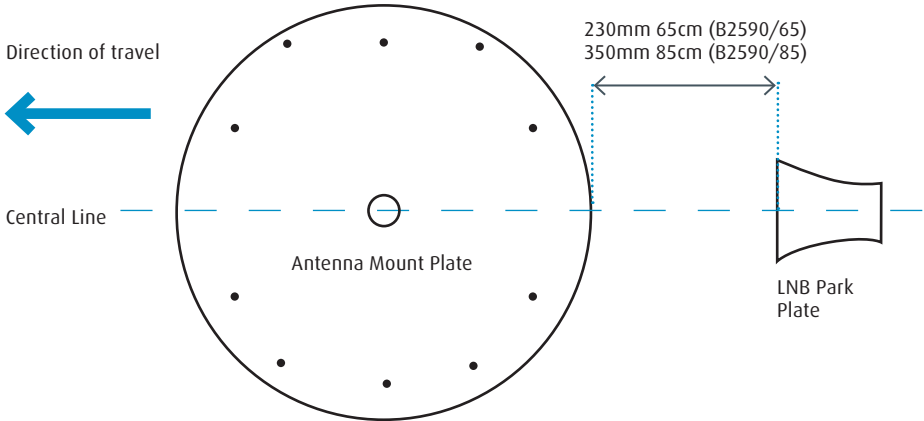

8. Drill 6 x 2.5mm pilot holes into the roof
9. Using a 32mm holesaw drill the centre hole through the roof

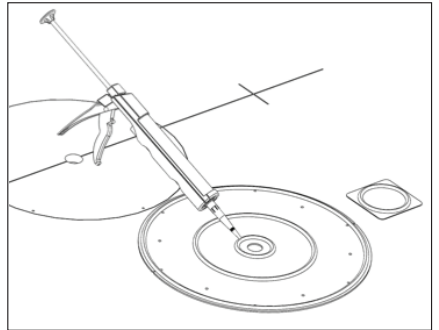

10. Apply rings of adhesive* (see page 4) to surface of Antenna Mounting Plate and LNB Park Plate and firmly place them into position.

Important Note:
Adhesive **MUST** be used to give a water tight seal between mounting plate and installation surface.

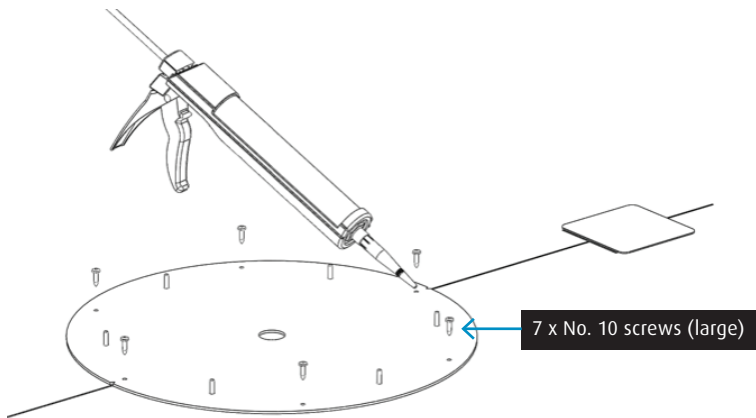

11. Place a small amount of adhesive into each pilot hole before screwing plate to roof.
12. Wipe off excess adhesive with a cloth.

Note:

- > Follow manufacturer’s instructions when applying adhesive. Do not travel until adhesive has cured noting that curing times vary with weather conditions.
- > Take care when working at heights. Always follow ladder manufacturer’s safety advice.
- > Use creeper boards where necessary to ensure roof construction can support your weight.
- > Power tools should be used in accordance with manufacturer’s instructions.

Attach Antenna Unit to Mounting Plate

Carefully lower the antenna unit onto the Mounting Plate and re-attach the M6 Nuts and Washers that were previously removed.

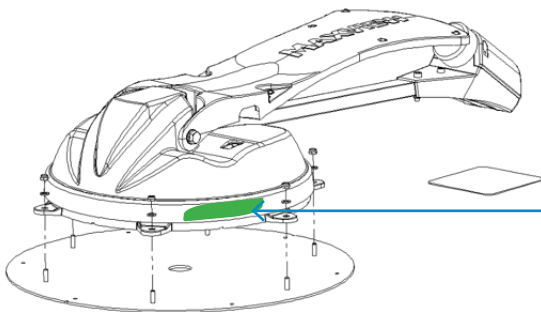

Note:
DO NOT remove transit tape x 2

Note: LNB image shows different model.

Caution: Replace Nylon locking nuts if they have been removed more than twice. The locking action of the Nylon becomes less effective if repeatedly assembled and disassembled.

Installing cables:

1. Check there are no hidden cables in the roof structure and that the hole location is clear of obstructions both internally and externally.
2. See below for Cable Entry Cover instructions

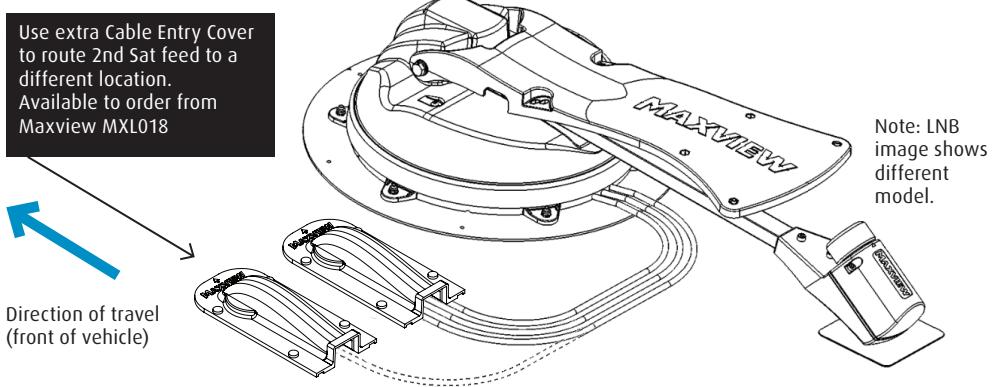

Note: To prevent trip hazards it is recommended that cables are concealed in PVCu conduit (not supplied) where access is required to the roof of the vehicle.

Installing Cable Entry Cover:

1. Plan your installation
2. Drill hole in roof
3. Prepare surface for adhesion
4. Apply sealant as shown in A,B,C (we recommend Sikaflex-512 Caravan)*
5. Position top hat
6. Position cable entry cover
7. Wipe excess sealant with a dry cloth

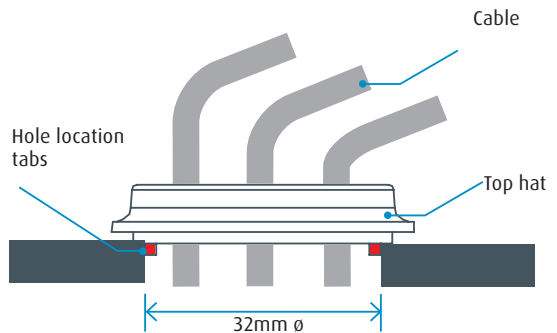

Applying sealant example:



 = Generously apply wet seal adhesive

Installing the handle:

Note: LNB image shows different model.



1. Push the aluminium tube into the plastic coupler and insert into the antenna unit through the hole in the ceiling. With the plastic coupler pushed up tight to the ceiling, mark the aluminium tube along all four sides.

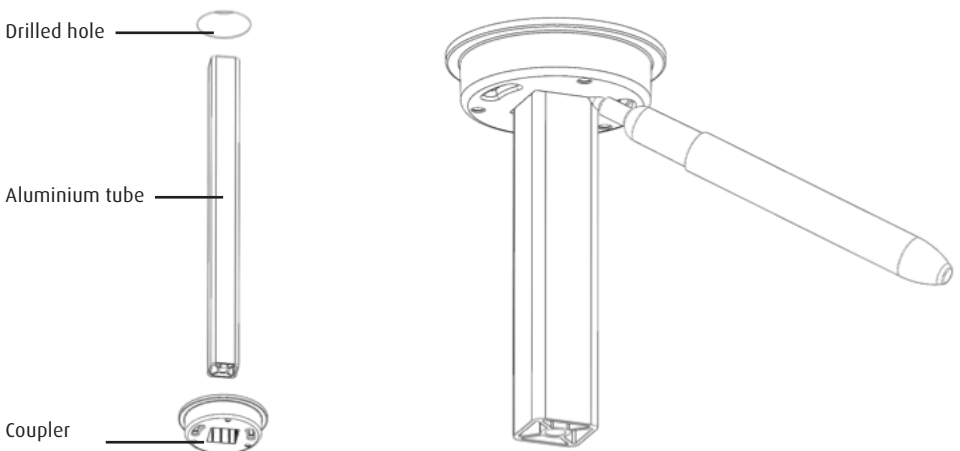

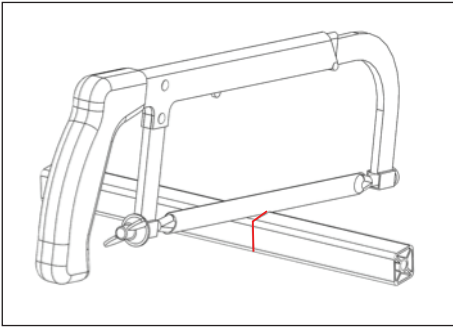

2. Cut the 20mm square tube with a hacksaw. Make the cut so that the line is left on the discarded part of the tube.

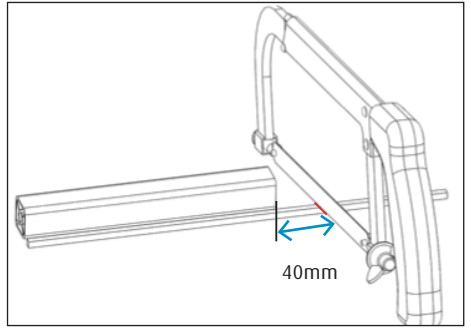

3. Now mark and cut the 4mm spindle so that it is 40mm longer than the tube.

4. With the Coupler Bush aligned to the rear of the vehicle insert the Tube and Coupler Bush through the ceiling hole and into the antenna unit.

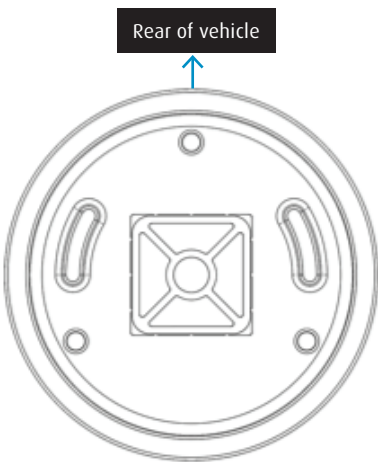

Aluminium Tube should not protrude past the coupler bush

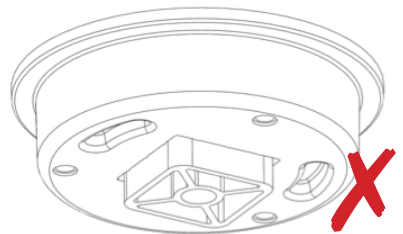
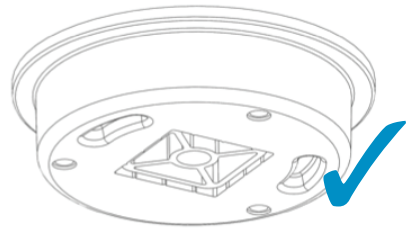

5. Place the Base Plate over the Coupler Bush. Point the arrow to the rear of the vehicle. Mark the four fixing holes. Drill four 2.5mm pilot holes or use a bradawl. With four No.10 screws fix the Base Plate to the ceiling.

6. Take the Dish Direction Unit and turn the azimuth lock lever to the red position to release the brake.

Locate the Dish Direction onto the Coupler Bush and use three M4 screws fix it in place.

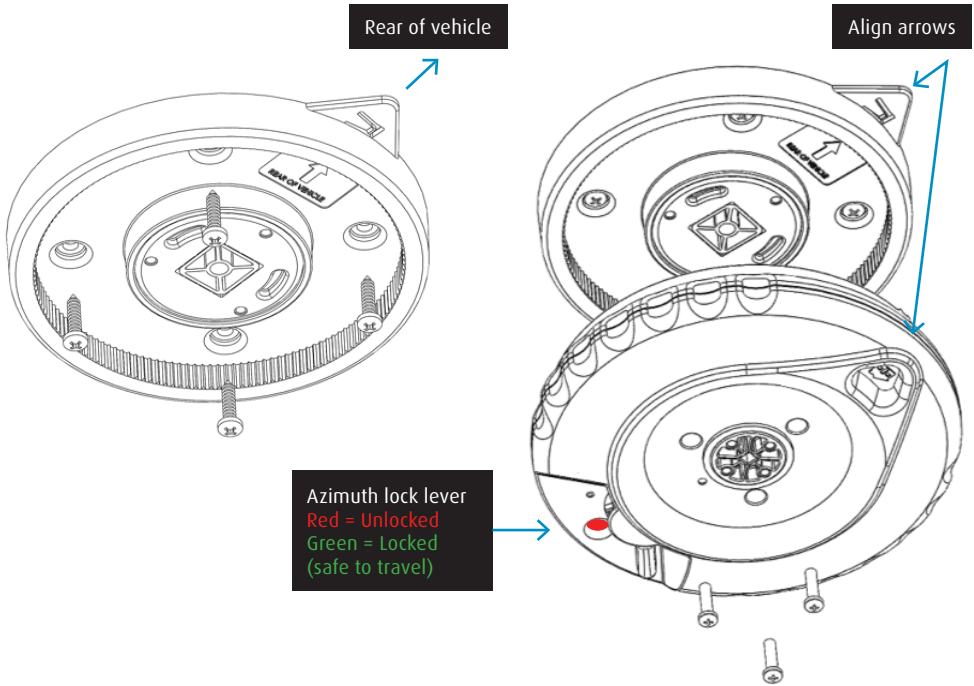

Note:
 Add the 2 x M5 washers as image below before fixing the elevation handle

7. Place the 4mm spindle into the elevation handle and fix to the Dish Direction Unit with two M4 screws.

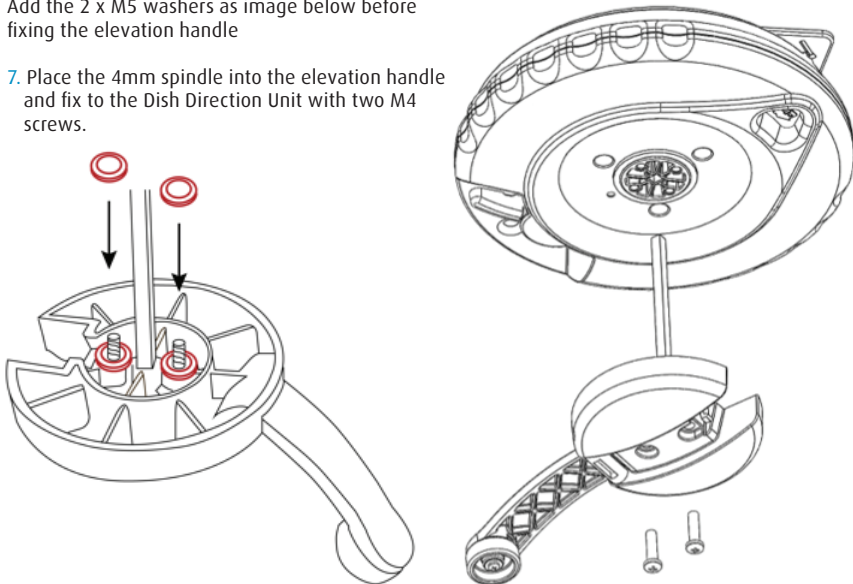

Attaching the Satellite Dish to the Antenna Unit

1. Ensure Antenna Unit is free from obstacles.
2. Turn the azimuth lock lever to the green position (locked for travel)
3. Elevate the antenna to 25 degrees (25 turns = 25 degrees)

Azimuth Lock is Green - LOCKED for travel
Wind handle clockwise 25 turns to reach 25 degrees

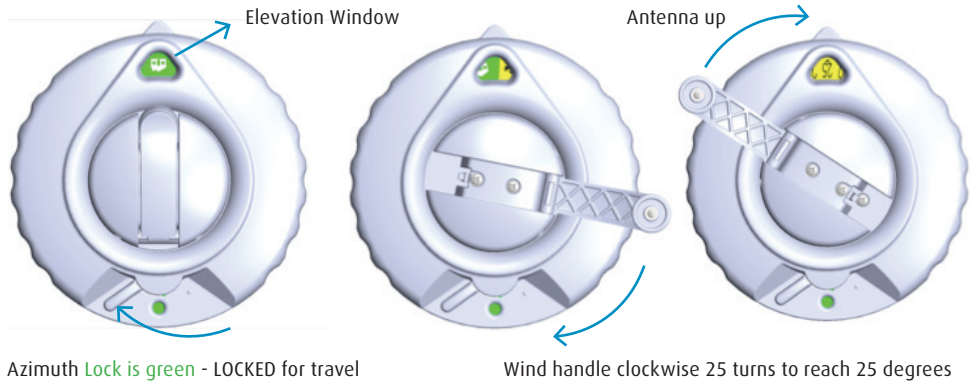

Note: The Home Position will go past the Elevation Window during the 25 turns, this is normal operation

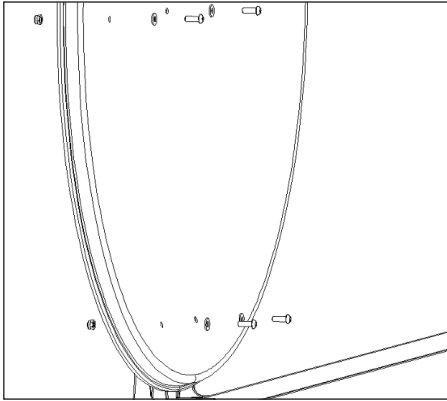

4. Fix satellite dish to Antenna Arm using M6 Button Head Screws, M6 Nuts and 6mm Plastic Washers. The 65cm and 85cm satellite dishes have different fixing hole positions. Therefore 4 of the holes will be unused.
5. Remove all tools, packaging and obstructions from roof.

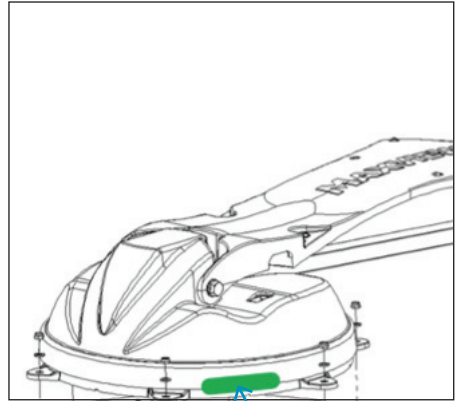

6. Finally, carefully remove the green transit tape from Antenna Unit in 2 places.

Caution: Replace Nylon locking nuts if they have been removed more than twice. The locking action of the Nylon becomes less effective if repeatedly assembled and disassembled.

Finding a Satellite

Before starting check there is a clear line of sight to the southern sky. All television broadcasting satellites have a geostationary orbit which means their location is fixed above the earth's equator. Satellites also have a limited range of transmission so use the Zone maps included in the appendix to check your location is suitable for reception. If your location is near the limit of reception it is recommended to adjust the skew angle of the LNB to maximise signal quality and strength (see page 16 for details)

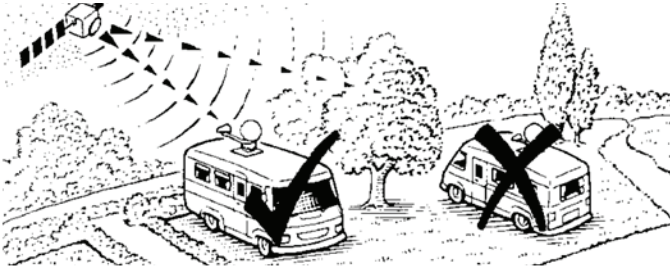

Note:

Ensure the TV and Satellite Receiver are connected in accordance to the manufacturer's instructions. The Zone map can be stuck to the wall if needed near the Dish Direction Unit.

Start a search

1. Open elevation handle
2. We recommend always winding the Antenna Handle 25 turns to 25 degrees as a starting position.
3. Determine the approximate dish elevation required from the zone map (see back page).
4. Adjust the elevation handle and wind to elevation shown on the zone map.
(Compensate the elevation angle accordingly if your vehicle is not level)

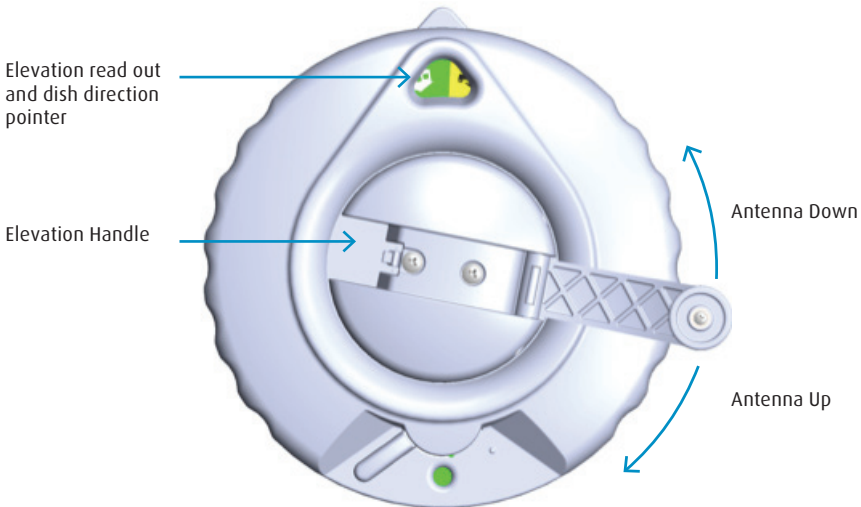

5. Now Turn the Azimuth Lock Lever to the RED position to disengage the brake and turn Dish Direction Unit to a South Easterly direction as indicated by the compass.
6. Slowly scan from South East to South whilst checking for a picture on the Television.
7. If no satellite is found adjust the elevation by 2 degrees and repeat the scan.



Unlock Azimuth Lock

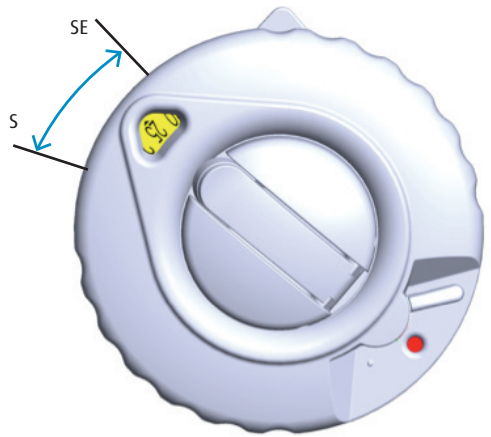

Rotate Dish Direction Unit

8. When the satellite is found fine adjustment of the satellite system may now be required to achieve the best possible signal.
9. Turn the Azimuth Lock Lever to the GREEN position to apply the brake.

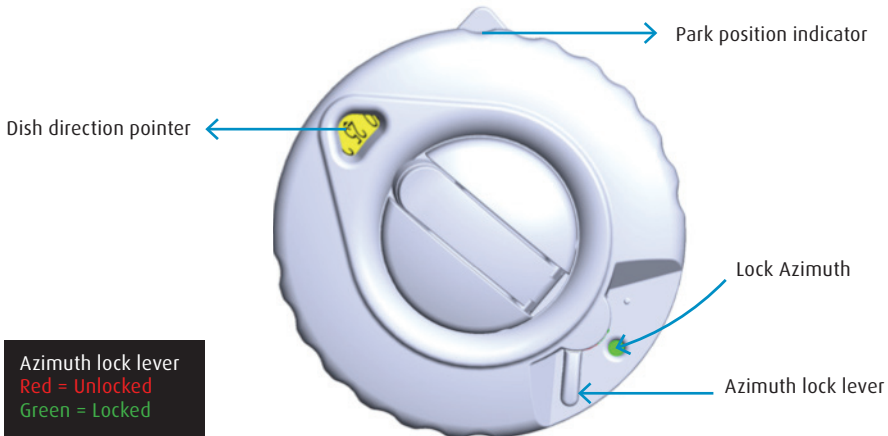

Azimuth lock lever
 Red = Unlocked
 Green = Locked

Lowering antenna:

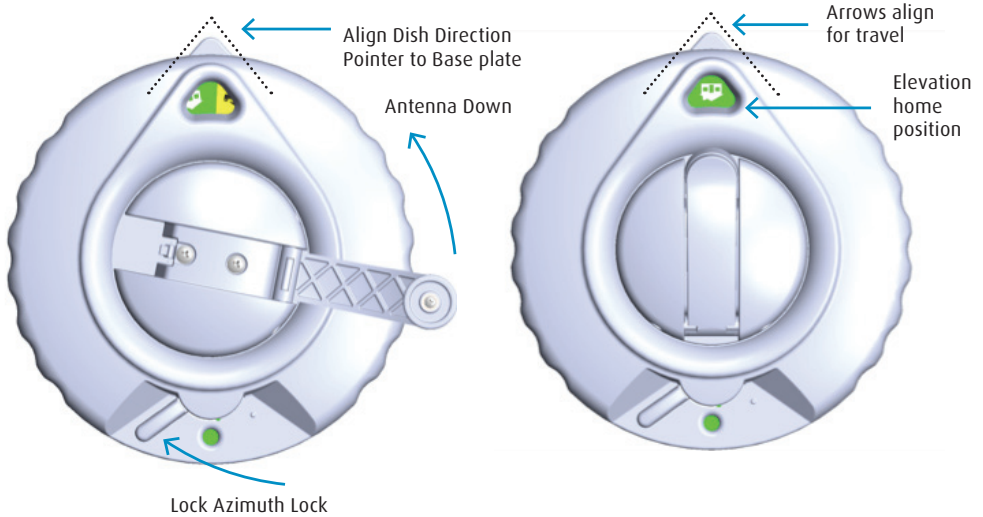

1. Rotate the Dish Direction Unit until it aligns with the Base Plate and Lock Azimuth (green).
2. Lower the antenna by rotating the Elevation Handle anti-clockwise (approximately 25 turns from 25 degrees until you see home position in the window).
3. Slowly turn the handle until elevation indicator fully shows the home position and you feel some park resistance. Do not over wind the handle as this may damage the satellite system.

NOTE: The Home Position will go past the Elevation window once during the lowering operation before you see the Home Position for the second time. This is normal operation.

CAUTION: As a manual system we always recommend the '3 point safety check'

Before travelling;

1. Elevation readout must show the Home position (check park resistance felt)
2. Azimuth Lock Lever must be in the Green Position and Park arrows aligned
3. Visual check on your roof to ensure the Antenna is fully lowered.

Skew adjustment:

Skew adjustment is required when signal strength is weak at the limit of a given satellites' reception area. It involves adjusting the angle of the LNB on the roof mounted antenna unit.

Caution:

Follow general safety advice on page 3 when adjusting Antenna Unit.



Note: LNB image shows different model.

Astra 2 - 28.2°

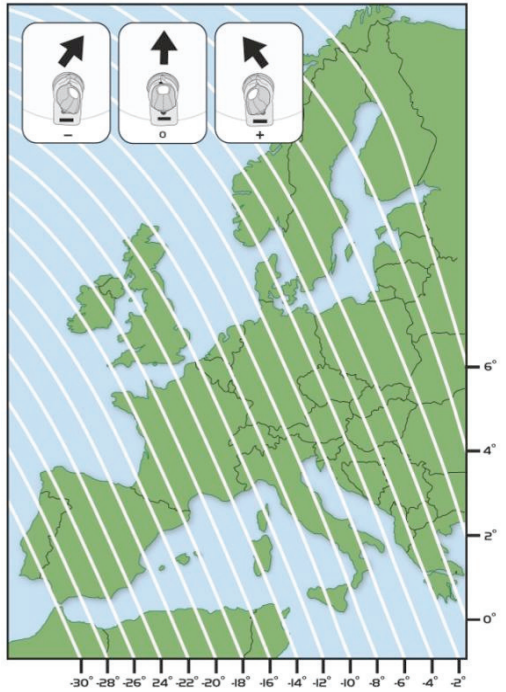

Astra 1 - 19.2°



3 year guarantee:

Every new Crank Up system is thoroughly inspected and tested before leaving the factory and is covered by our three years guarantee from the date of original purchase.

Maxview is responsible for the cost of a replacement part if the original part is determined to be defective under the terms of guarantee. The customer is responsible for the cost of replacement parts after three years. This guarantee does not cover installation or external wiring.

Should any trouble develop during the guarantee period please contact Maxview before the expiry date.

If you do experience a problem with the product contact Maxview Customer Services on +44 (0)1553 811000 or email support@maxview.co.uk

Please make sure you have the following ready when you call:

- **Model number** • **Serial number** • **Date of purchase** • **Clear and concise details of the fault**
- **Details of who installed the product**

The warranty does not apply where:

- The product has been abused, misused, improperly installed or improperly maintained.
- Repairs have been made or attempted by a third party other than Maxview
- Repairs are required due to normal wear and tear
- Modifications have been made to the product
- The antenna unit has been opened
- Damaged caused by abrasive cleaning or power washing
- Circumstances beyond the control of Maxview that have caused the product to no longer operate correctly
- Customer is not the original owner or cannot provide proof of purchase

In no event shall Maxview be liable for any indirect, incidental, or consequential damages from the sale or use of the product. This disclaimer applies both during and after the term of the warranty. This does not affect your statutory rights

Specifications:

Operating: Low stream line profile, only 17cm in park position	
Power: Powering:	Manual operation no power required
System: Elevation Range: Azimuth Range: Skew Angle: Cable Type: UV Protection: Testing:	10° to 70° 380° ±45° CAI approved 100 coaxial cable All external plastic parts are UV stabilised Fully weatherproof and watertight construction System has passed extensive water ingress test
LNB: Type: Output: Typical Gain: Frequency Range: Arm Cable:	High Quality 0.2dB Universal Twin LNB Twin 65cm - 36dB 85cm - 38.1dB 10.7-12.75GHz RG179
Antenna: Material: Reflector Thickness: Finish: Outside Dims: Reflecting Dims:	Aluminium 1mm Powder coated with U.V. inhibited polyester-based 65cm dish: 67.0 x 71.5 cm 85cm dish: 85.0 x 90.5 cm 65cm dish: 63.0 x 67.5 cm 85cm dish: 81.5 x 87 cm
Mounting: Plate Material: Fixing Method: Fixing Studs: Cable Entry:	Aluminium Recommended adhesive (Sikaflex, Geocel or equivalent) 6 x M5 studs for system removal Coaxial cable joining cover under antenna system

Quick reference table:

Your locations - Add your favourite locations for quick reference for future use

Satellite	Location	Elevation (degrees)	Number of turns	Notes
Astra 28.2E	King's Lynn	25	25	Crank Up Manufacturer Location

MAXVIEW

Est 1964

Satellite Zone Map

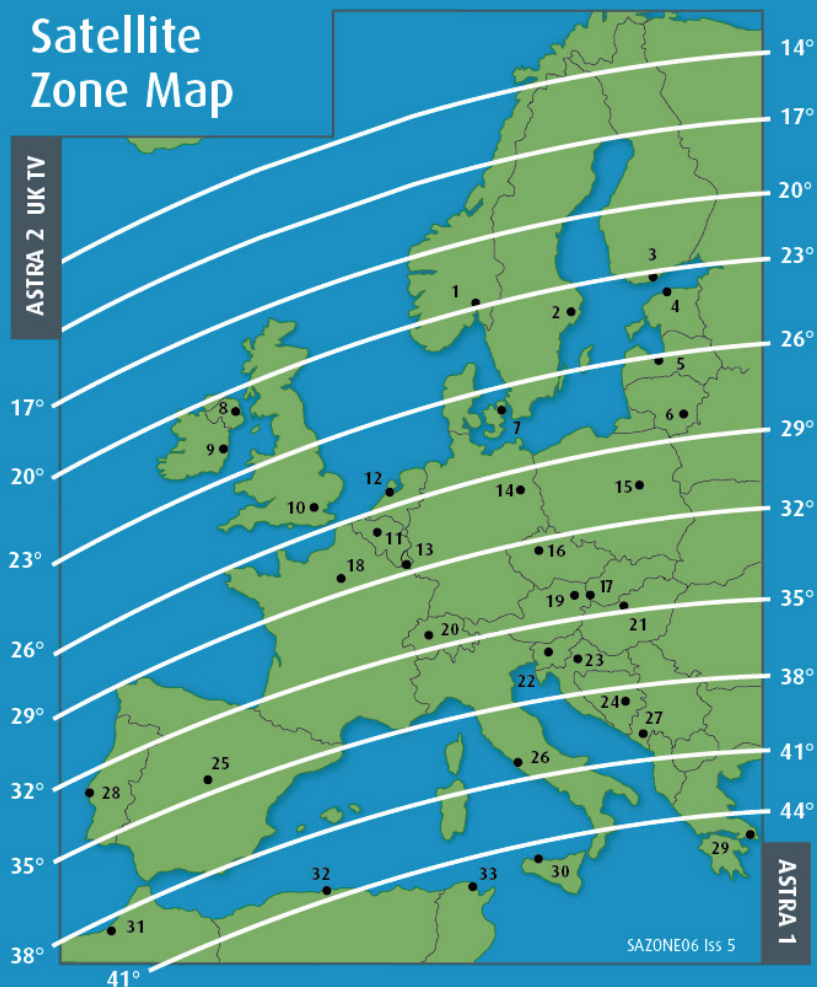

- | | | | |
|-------------------------------|---------------------------------|---------------------------|-----------------------|
| 1. Norway (Oslo) | 9. Republic of Ireland (Dublin) | 17. Slovakia (Bratislava) | 25. Spain (Madrid) |
| 2. Sweden (Stockholm) | 10. Great Britain (London) | 18. France (Paris) | 26. Italy (Rome) |
| 3. Finland (Helsinki) | 11. Belgium (Brussels) | 19. Austria (Vienna) | 27. Serbia (Belgrade) |
| 4. Estonia (Tallinn) | 12. Netherlands (Amsterdam) | 20. Switzerland (Bern) | 28. Portugal (Lisbon) |
| 5. Latvia (Riga) | 13. Luxembourg | 21. Hungary (Budapest) | 29. Greece (Athens) |
| 6. Lithuania (Vilnius) | 14. Germany (Berlin) | 22. Slovenia (Ljubljana) | 30. Sicily (Palermo) |
| 7. Denmark (Copenhagen) | 15. Poland (Warsaw) | 23. Croatia (Zagreb) | 31. Morocco (Rabat) |
| 8. Northern Ireland (Belfast) | 16. Czech Republic (Prague) | 24. Bosnia (Sarajevo) | 32. Algeria (Algiers) |
| | | | 33. Tunisia (Tunis) |

Product serial number, Seriennummer.

UK Helpline: +44 (0) 1553 811000

EU Helpline: +49 (0) 8145 996998-0

