

Camec Chrome Plated Hand Pump

Self-Priming, Dual Action
Easy installation. Ideal for RV,
boating and camping use.
Recommended for drinking water.



Care:
Clean with a soft damp cloth and mild
detergent if necessary.

1

Using a hole saw, cut
a 32mm hole in bench
surface. Maximum
thickness 16mm

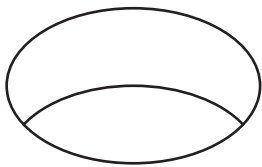

2

Place Pump Assembly through hole.

Pump Assembly

Benchtop

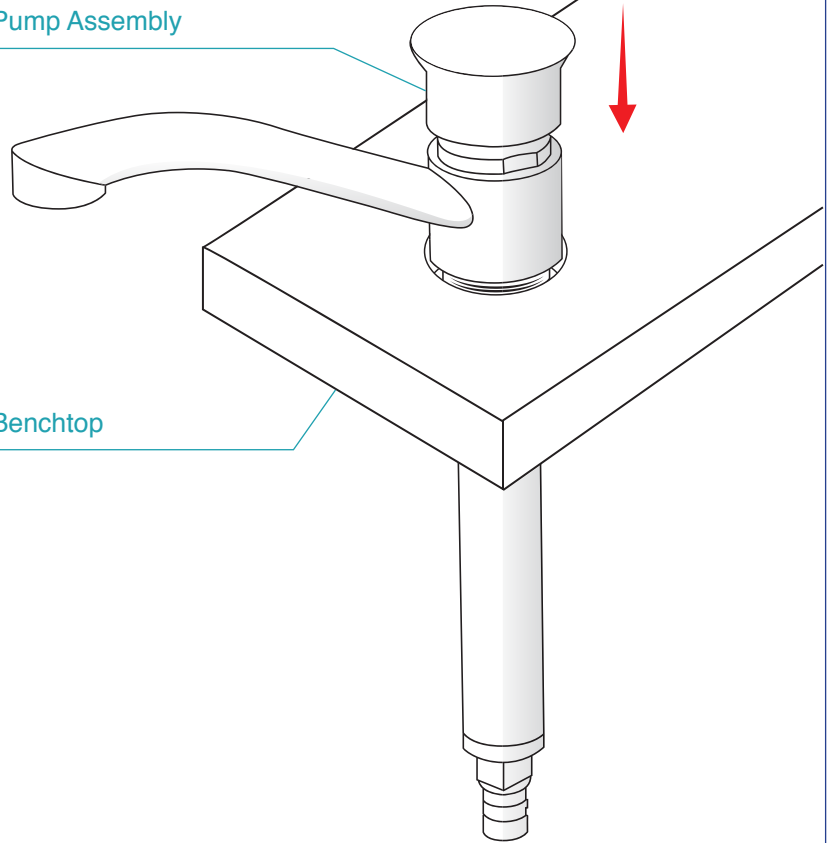

3

Screw
Locknut from
underneath
bench.

Tighten
firmly

Locknut

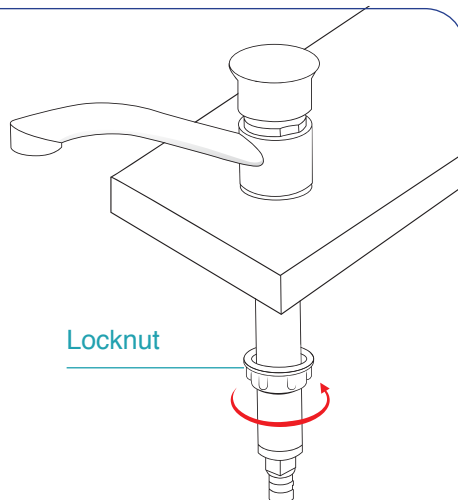

4

Connect
12.7mm
or 1/2" ID
flexible hose
to pump spigot
and secure with
a hose clamp.

**TEST & CHECK
FOR LEAKS**

Pump Spigot

Flexible hose
(not supplied)

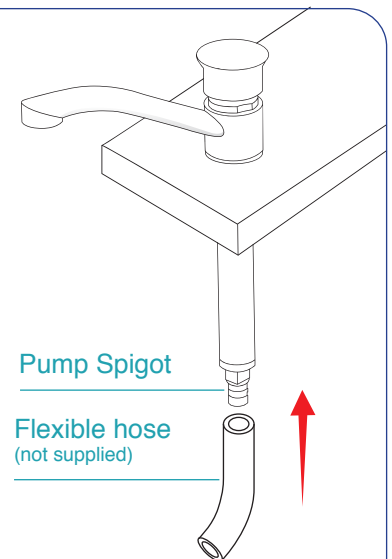

Aus: Camec Head office 47-63 Remington Drive Dandenong South, 3175, Victoria, Australia Phone: 1300 422 632
NZ: Airport Business Centre 44 Montgomerie Rd Mangere, Auckland Phone: 03 257 2419

Camec Repair or Replacement Guarantee

In the unlikely event in Australia or New Zealand that this Camec product develops any malfunction within one year of the date of original purchase due to faulty materials or manufacture, Camec will at our option repair or replace it for you free of charge, subject to the conditions below. Should you experience any difficulties with your Camec product, we suggest in the first instance that you contact the store from which you purchased the Camec product. Alternatively you can send a written letter to Camec at the address listed below. On receipt of your claim, Camec will seek to resolve your difficulties or, if the product is faulty or defective, advise you on how to have your Camec product repaired, obtain a replacement or a refund. Your Camec One Year Guarantee naturally does not cover normal wear or tear, replacement of product consumables (e.g. seals), loss or damage resulting from misuse or negligent handling, improper use for which the product was not designed or advertised, failure to properly follow the provided installation and operating instructions, corrosive or abrasive water or other liquid, or unauthorized persons attempting repairs. Your Camec One Year Guarantee does not cover freight or any other costs incurred in making a claim. Please retain your receipt as proof of purchase; you MUST provide evidence of the date of original purchase when claiming under the Camec One Year Guarantee. Camec shall not be liable for any loss of profits or any consequential, indirect or special loss, damage or injury of any kind whatsoever arising directly or indirectly from Camec products. This limitation does not apply to any liability of Camec for failure to comply with a consumer guarantee applicable to your Camec product under the Australian or New Zealand legislation and does not affect any rights or remedies that may be available to you under the Australian or New Zealand Consumer Legislation. In Australia, you are entitled to a replacement or refund for a major failure and for compensation for any other reasonably foreseeable loss or damage. You are also entitled to have the goods repaired or replaced if the goods fail to be of acceptable quality and the failure does not amount to a major failure. Should your Camec product require repair or service after the guarantee period; contact your nearest Camec Dealer or phone the Camec Customer Service Centre on the number listed above.