

## WARRANTY

### 5.0 Warranty Claims

- 5.1 If a fault covered by the Warranty occurs, the Purchaser must first contact Camec.
- 5.2 Contact with Camec may be made in any of the following ways:
- Phone 1300 654 936 (Australia) or (09) 257 2419 New Zealand
  - Fax 03 9799 4476
  - Email
- 5.3 Any Warranty claim from the Purchaser must be accompanied by:
- Proof of purchase;
  - Installation details (if applicable);
  - Return of Product (unless otherwise advised);
  - Full details of the alleged defect; and
  - If applicable, evidence of maintenance performed in accordance with the relevant maintenance schedules.
- 5.4 The cost of delivery and insurance of the Product to and from Camec and the cost of testing the Product are the responsibility of the Purchaser.
- 5.5 Where it is deemed that the Product does not have a fault, the Purchaser will be charged a testing fee of \$55.00 (GST exclusive), this is subject to change without notice.

### 6.0 Returns

- 6.1 Subject to clause 6.2, Camec may, at its absolute discretion, accept returns of non-defective Products purchased within 30 days of invoice date. If accepted by Camec, returns for Products will incur a re-stocking fee of 25% of the invoiced price, payable on return of the Products.
- 6.2 If the Purchaser is a consumer under the ACL, nothing in clause 6.1 limits any remedy available for a failure of the guarantees in sections 56 and 57 of the ACL.



## Compact RV Washing Machine

2.5kg/3.0kg

# OPERATION MANUAL

3.0kg Part Number: 044131

2.5kg Part Number: 041133



# INDEX

Parts Identification and Accessories . . . . .	2
Safety Information . . . . .	3
Installation . . . . .	4
Control Panel Layout . . . . .	7
Wash Times & Water Usage . . . . .	9
Operation . . . . .	10
Cleaning and Maintenance . . . . .	11
Troubleshooting and Specifications . . . . .	12
Error Codes & Functions . . . . .	13
Warranty . . . . .	14



# WARRANTY

## PRODUCT WARRANTY: IMPORTANT INFORMATION PLEASE READ CAREFULLY:

If your product is faulty or you are experiencing difficulties using this product and require assistance please call our warranty hotline as listed below:

<b>AUS 1300 654 936</b>	<b>Camec Pty Ltd</b> 47-63 Remington Drive, Dandenong South VIC 3175
<b>NZ (09) 257 2419</b>	<b>Camec NZ</b> 44 Montgomerie Road, Mangere, Auckland, 2022

- 1.0 Definitions**  
The terms listed below shall have the following meanings:  
"Camec" means Camec Pty Ltd (ACN 004 846 584) of 47-63 Remington Drive, Dandenong South, Victoria 3175.  
"Purchaser" means the persons, firm or company being supplied with Products and / or services.  
"Product" means the equipment purchased by the Purchaser to which this Warranty applies.  
"Manufacturer" means the original company who created the Product.
- 2.0 Terms of Warranty**
  - 2.1 Camec warrants that, subject to the exclusions and limitations below, the Product will be free from defects in materials and workmanship under normal use and maintenance for a period of 12 months from the date of supply to the original Purchaser ("Warranty Period"), unless otherwise specified.
  - 2.2 The date of supply to the Purchaser must be evidenced by the original invoice.
  - 2.3 If a defect appears in the Product before the end of the Warranty Period and Camec finds the Product to be defective in materials or workmanship, Camec will, in its sole discretion, either:
    - a) replace or repair the Product or the defective part of the Product free of charge;
    - b) cause the Product or the defective part of the Product to be repaired or replaced by a qualified repairer free of charge; or
    - c) provide payment of the cost of having the Product replaced (or acquiring an equivalent Product) or repaired, or services re-supplied.
  - 2.4 Camec reserves the right to replace defective parts of the Product with parts and components of similar quality, grade or composition where an identical part or component is not available.
  - 2.5 Products presented for repair may be replaced by refurbished goods of the same type rather than being repaired. Refurbished parts may be used to repair the Products.
  - 2.6 This Warranty is in addition to any warranties imposed by Australian State and Federal legislation that cannot be excluded.
  - 2.7 Our goods come with guarantees that cannot be excluded under the Australian Consumer Law ("ACL"). You are entitled to a replacement or refund for a major failure and for compensation for any other reasonably foreseeable loss or damage. You are entitled to have the goods repaired or replaced if the goods fail to be of acceptable quality and the failure does not amount to a major failure.
- 3.0 Exclusions**
  - 3.1 The Warranty will not apply where:
    - a) the Product has been on-sold or assigned by the Purchaser;
    - b) the Product has been re-installed;
    - c) the Product has been modified or repaired by someone other than Camec or an authorised Camec agent;
    - d) the Product's defect has arisen due to the Purchaser's failure to properly install, fit, maintain, service or use the Product in accordance with the specifications and instructions provided by the Manufacturer, including a failure to comply with the relevant maintenance schedule (where applicable);
    - e) Camec cannot establish any fault in the Product after testing;
    - f) The Product has been used other than for the purpose for which it was designed;
    - g) The Product has been subject to abnormal conditions, including but not limited to temperature, pressure, stress, load or similar;
    - h) The Purchaser or installer has used or fitted non-genuine or non-approved parts and accessories to the Product or has failed to use recommended parts and accessories;
    - i) The Product's defect has arisen due to abuse, misuse, neglect or accident; or
    - j) The Product has not been installed in accordance with the relevant instructions.
  - 3.2 The Warranty will not extend to:
    - a) fair wear and tear of the Product; or
    - b) expendable parts.
- 4.0 Limitations**
  - 4.1 Camec makes no express warranties or representations other than those set out in this Warranty.
  - 4.2 If a Product was received damaged, it must be returned to Camec within 7 days for warranty purposes.
  - 4.3 Camec is not responsible for the installation of the Product. Any fault or defect due to installation should be referred to the installer. The Product must be installed in accordance with the Manufacturer's instructions and any relevant legislation or code.
  - 4.4 The repair or replacement of the Product or part of the Product or the cost of re-supplying the services or repairing or replacing the Product is the absolute limit of Camec's liability under this express warranty.

## ERROR CODES & FUNCTIONS

### ERROR CODES & SUGGESTED SOLUTIONS

ERROR CODE	FAULT SYMPTOM	SUGGESTED SOLUTION
LCD displays flashing "E1" error	No water fill alert	- Check that the water tap is on - Check mains pressure or water pump operation - Check the water inlet filter <i>After following the steps above, open and close the lid to reset the washing machine</i> <i>If the error persists, please call Camec.</i>
LCD displays flashing "E2" error	Lid open alert	- Ensure the lid is completely closed and/or its hinge(s) are not broken. <i>If the error persists, the error could be related to a faulty lid magnet sensor or faulty PCB.</i> <i>Please call Camec for further advice.</i>
LCD displays flashing "E3" error	Out of balance alarm	- Ensure that the washing machine is level & stable, adjust if required - If the clothes are uneven, adjust the distribution of the load <i>After following the steps above, open and close the lid to reset the washing machine</i> <i>If the error persists, please call Camec.</i>
LCD displays flashing "E4" error	Drainage alarm	- Ensure the drain hose bend is no higher than 100mm from ground level - Do not cover the end of the drain pipe, it MUST drain freely <i>After following the steps above, open and close the lid to reset the washing machine</i> <i>If the error persists, please call Camec.</i>
LCD displays flashing "F1" error	Water level alarm	- Potential faulty water level sensor alarm or faulty level sensor connection hose - Potential PCB fault <i>Please the Camec warranty department for advice and spare part supply.</i>

### Automatic power off function

1. If the washing machine is turned on but not used for 10 minutes, the machine will switch off automatically to save power.
2. After the washing cycle is complete, the machine will beep 6 times to indicate the cycle has finished and will turn off to save power.

### Out of balance adjustment

1. If the load becomes badly unbalanced during the spin cycle the washer will stop, re-balance by entering rinse mode, then continue spinning.
2. This adjustment will activate twice if needed. If this does not fix the problem, the alarm "E3" will be displayed. If this is the case, please try re-positioning the load by hand or reduce the amount of clothes in the tub.

## PARTS IDENTIFICATION & ACCESSORIES

### Names of Respective Parts

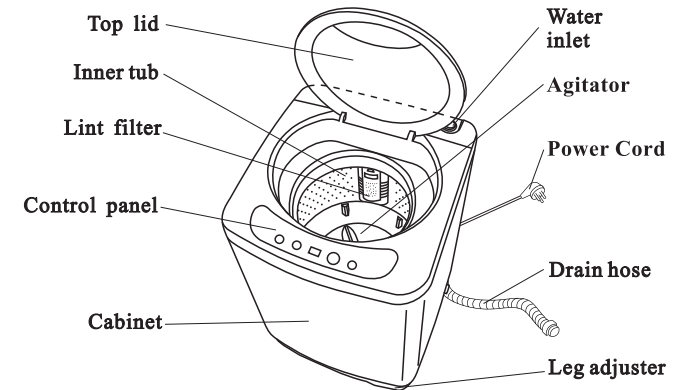

### Accessories

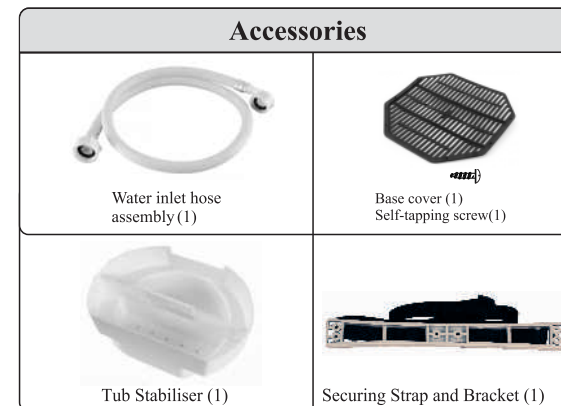

## SAFETY INFORMATION

### Precautions

#### Power Safety

This washing machine is designed for Australian and New Zealand earthed 3-pin 240V outlets only.

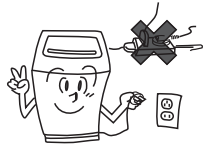

#### Dry Area Installation

To reduce the risk of Electric shock, do not install the washing machine in extremely high areas of moisture. Alternatively, ensure the washing machine is housed in a suitable enclosure or cupboard.



#### Don't use hot water

This washing machine is for cold water use only!



#### Do not place your hands in the tub while spinning

Please do not open the lid while the unit is in operation. It is very dangerous to place your hands in the tub while it is spinning.



#### Avoid Splashing

Do not spray the washing machine with water, to clean use a damp soft cloth and wipe as required.



#### Keep away from smoke and fire

Don't place lighted candles, cigarettes, mosquito repellent incense and thermos bottles nearby to avoid the risk of fire and damage to plastic components.



This appliance is not intended for use by persons (including children) with reduced physical, sensory or mental capabilities, or lack of experience and knowledge, unless they have been given supervision or instruction concerning use of the appliance by a person responsible for their safety.

## TROUBLESHOOTING & SPECIFICATIONS

### Troubleshooting

Symptom	Cause	Suggested Solutions
No indication in controller	<ul style="list-style-type: none"> <li>* The power lead may be Disconnected.</li> <li>* The power point may be off.</li> <li>* The machine is not switched on or is in Auto power off function.</li> </ul>	<ul style="list-style-type: none"> <li>* Check the power lead to the machine and power point is on.</li> <li>* Check the RV's safety switch or circuit breaker on the power supply pole</li> <li>* Press the "POWER" button.</li> </ul>
* Leaking from the Water Inlet hose or fittings.	<ul style="list-style-type: none"> <li>* Incorrect fitment of the inlet hose.</li> <li>* Faulty Water inlet hose.</li> </ul>	<ul style="list-style-type: none"> <li>* Check for correct fitment.</li> <li>* Replace water inlet hose.</li> </ul>
Drain failure	<ul style="list-style-type: none"> <li>* The Drain hose is mounted too high.</li> <li>* The drain hose may be clogged or blocked.</li> </ul>	<ul style="list-style-type: none"> <li>* Adjust the drain hose.</li> <li>* Check that the drain hose is not blocked and can flow freely.</li> </ul>
* Water fill failure	<ul style="list-style-type: none"> <li>* Poor Water pressure</li> <li>* Restricted water inlet filter</li> </ul>	<ul style="list-style-type: none"> <li>* Check water supply connections.</li> <li>* Check water inlet filter screen.</li> </ul>
* Water fill during Spin cycle	* Clothes are uneven in the tub	* If the clothes are uneven around the spin dry tub, the safety device will activate and may stop the spin process, the washer may automatically revert to rinse mode to help to adjust the washing load. After the tub is balanced the spin mode will resume.
* No spin mode after Rinse mode.	* The lid has been opened and may not be closed.	* Check to ensure that the lid is correctly closed.

### Specifications

Model	Size	Weight	Rated wash & spin load	Rated Power Input
<b>2.5kg - 041133</b>	410 x 420 x 640mm	16kg	2.5kg (dry clothes)	235W max
<b>3.0kg - 044131</b>	410 x 420 x 740mm	18kg	3.0kg (dry clothes)	1035W max
<b>2.5 &amp; 3kg models</b>				
<b>Rated Voltage</b>		240V~	<b>Rated Frequency</b>	50Hz
<b>Maximum water pressure permitted @ water inlet</b>		0.6Mpa	<b>Minimum water pressure permitted @ water inlet</b>	0.1Mpa

**Note:** Ensure that a pressure limiting valve is used if the pressure is outside the above specifications.

## CLEANING & MAINTENANCE

### Procedures

Prior to any maintenance or service, please ensure that the power and water have been disconnected from the machine.

#### When the cycle is complete

At the end of a cycle, the machine will beep to alert you that the cycle is complete. Remove the clothes from the washing machine and insert the Tub Stabiliser in preparation for transit.

To reduce the risk of electric shock and water leakage, disconnect the water & power supply when not in use.

#### Lint Filter Cleaning

After each completed washing cycle ensure that the Lint filter is cleaned.

1. Remove the lint filter from the tub.
2. Carefully open the filter and remove the lint.
3. Refit the lint filter into the unit.

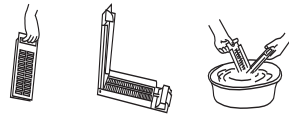

#### Cabinet Cleaning

Use a soft damp cloth to clean the washing machine. Avoid the use of chemicals or harsh detergents as they may damage the surface of the washing machine.

#### Water Inlet

Periodically check and clean the water inlet filter to ensure it is not clogged. To do this,

1. Turn off the water tap and then turn on the washing machine.
2. Start a washing cycle allowing it to continue for approximately 5 seconds (this is to remove any pressure in the water hose). After this, turn off the washing machine.
3. Remove the water inlet hose and take out the water inlet filter from the inlet valve. Clean the filter, refit and reconnect the water inlet hose.



## INSTALLATION

### Installation Notes

- Step 1. The washing machine should be placed inside the RV with a flat floor, which is convenient for water supply and drainage, with low moisture and no direct sunlight, and is not subject to freezing in winter.
- Step 2. All foam packing (including the fixing frame on the base foam) should be removed, otherwise the washing machine will not operate correctly.
- Step 3. Adjust by either screwing in or out the leg adjuster and when the machine is level on all 4 corners, lock off the outer adjustment to hold in place. (The leg adjuster is located on the front right hand side of the machine).

#### NOTE:

If the washing machine is not placed flat (the inclination angle is over 2 degrees), it may cause vibration or automatic shutdown and reset.

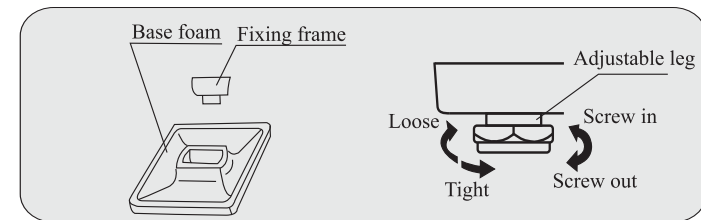

#### Step 4: Installation of the base cover

Lay the washing machine down on its front side and rest on a soft blanket and screw the lower base cover in place using a phillips head screwdriver.

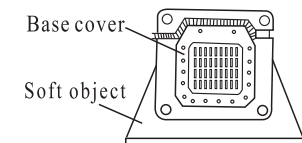
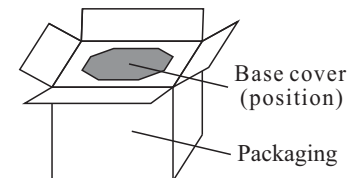

#### NOTE:

The washing machine must not be installed on carpet pile, as this can block the ventilation of the unit.

## INSTALLATION

### Installation Notes (cont'd)

#### Step 5. Installation of the water inlet hose.

1. Connect the 90 degree end of the water inlet hose to the washing machine.
2. Connect the other end of the water inlet hose to the COLD water outlet.
3. Ensure that the fitting is not forced or cross threaded as this will damage the fitting.
4. Turn on the tap to fill the line with water, check the hose fittings to make sure that no water leaks are observed. If water is leaking, turn the tap off and check all connections.

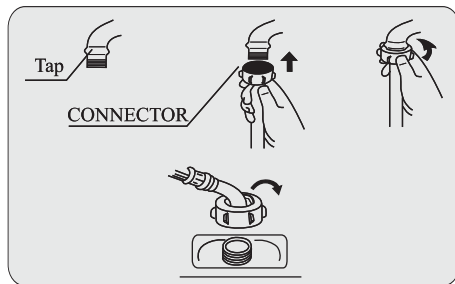

#### NOTE:

Please ensure you use a new water inlet hose during installation. If washing machine is installed in a new location or RV, use a new hose.

#### Step 6. Power source and grounding.

The washing machine requires a 240V alternating current (AC) power source.

The washing machine will work within a tolerance of 10% of its rated voltage. A dedicated power point should be used where possible to ensure the washing machine receives the correct voltage.

Please see overleaf for correct 240V connection.

## OPERATION

### Preparation and Operation

1. Check that the drain hose is correctly installed (and has not fallen out of its inlet)
2. Connect the water inlet hose and turn on the tap.
3. Insert the power plug in the socket and turn on.
4. Select water level according to the size of the load (refer page 9)
5. Select the wash mode (as per your specific model - see below)
6. Add detergent, close the lid & press START/PAUSE to start the load.

#### 3kg Model With Hot Wash Option

##### Program Selection

To select a desired wash program, press the **WASH MODE** button repeatedly. This will allow you to select combinations of **WASH, RINSE & SPIN** (full cold cycle), or **HOT WASH** (full hot cycle), or **WASH** only, or **WASH & RINSE**, or **RINSE & SPIN**, or **SPIN** only.

The Hot Wash function heats cold water supplied to the machine to a temperature of between 35°C and 40°C. This heating process can take up to 60 minutes (depending on the temperature of the water supplied to the machine) - during which time the machine will gently circulate the water every 15 minutes. In practice, the heating time usually takes 20-40 minutes in warmer weather. The "HEATING" LED will flash while the water is heating.

##### Wash Time Remaining Display

The wash time will initially be displayed as 90 minutes on the LCD display and as the water is heated, it will count down from there. As soon as the water is up to temperature, the HEATING LED will stop flashing and the wash time will be adjusted to show the remaining actual wash cycle time.

##### Hot Wash Load Size

Please note that Hot Wash is only available for smaller washing loads (up to 2kg) and the LOW water mode will automatically be selected when Hot Wash is selected. The high water level is not available for the HOT WASH cycle.

#### 2.5kg Model

##### Program Selection

To select a desired wash program, press the **WASH MODE** button repeatedly. This will allow you to select combinations of **WASH, RINSE & SPIN** (full cycle), or **WASH & RINSE**, or **RINSE & SPIN**, or **WASH** only, **RINSE** only, **SPIN** only or **QUICK WASH**.

#### For 2.5kg & 3kg Models

After the cycle has started, if you want to change the **WASH MODE** or **WATER LEVEL**, please press the **START/PAUSE** button, re-set your desired mode, then press the **START/PAUSE** again to start the new cycle.

##### Pre-wash for extra soiled clothes.

For seriously stained or dirty clothes, run the **RINSE/SPIN** cycle to perform a pre-wash, then add laundry detergent and select a full **WASH/RINSE/SPIN** cycle to complete washing.

## WASH TIMES & WATER

### Wash Cycle Chart

#### 2.5kg Model

CYCLE	Wash Time (min)	Rinse Time* (min)	Spin Time (min)	Approx Total Time (min)
WASH/RINSE/SPIN	12	16	7	38
WASH/RINSE	12	16	n/a	31
RINSE/SPIN	n/a	16	7	24
SPIN	n/a	n/a	7	7
RAPID WASH	8	8	5	21

\* Rinse cycle includes drain & spin, water in & rinse, drain & spin, water in & rinse.

#### 3.0kg Model

CYCLE	Wash Time (min)	Rinse Time* (min)	Spin Time (min)	Approx Total Time (min)
WASH/RINSE/SPIN	12	16	7	38
WASH/RINSE	12	16	n/a	31
RINSE/SPIN	n/a	16	7	24
SPIN	n/a	n/a	7	7
HOT WASH	62(heating)+8(wash)	15	5	90

\* Rinse cycle includes drain & spin, water in & rinse, drain & spin, water in & rinse.

### Suggested Water Settings and Usage

#### 2.5kg Model

Weight of load.	Suggested Water Level	Water Usage
1.0~2.5kg	High	Approx 20L
<1.0kg	Low	Approx 15L

#### 3kg Model

Weight of load	Suggested Water Level	Water Usage
2.0~3.0kg	High	Approx 26L
<2.0kg	Low	Approx 20L

## INSTALLATION

### NOTE:

The 240V outlet to be used for the Washing Machine must be installed by a qualified Electrician.

The washing machine's power cable incorporates active & neutral current plus an earth connection. Replacement of this cable should be carried out by an Authorised Service Agent or Electrician only.

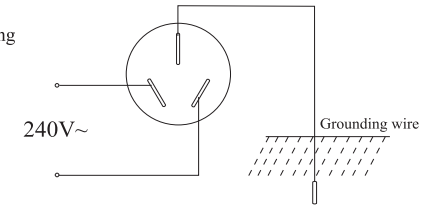

### Step 7: Adjustment of the Drain Hose location (factory position is the right-hand side)

1. Lay the washing machine down and rest on a soft object. Use a phillips head screwdriver to remove the base cover.
2. Pull the drain hose out from the groove, turn to the left and place back in to the groove.

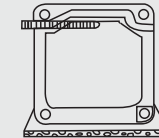
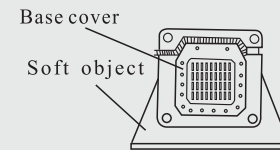

3. Replace the base cover.

### Step 8: Drain hose location

The drain hose must not be higher than 100cm from ground level.

### NOTE:

Make sure that the drain hose can not be blocked, as this will lead to a drain alarm fault.

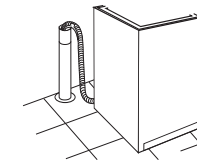



## CONTROL PANEL LAYOUT

### 2.5kg Model

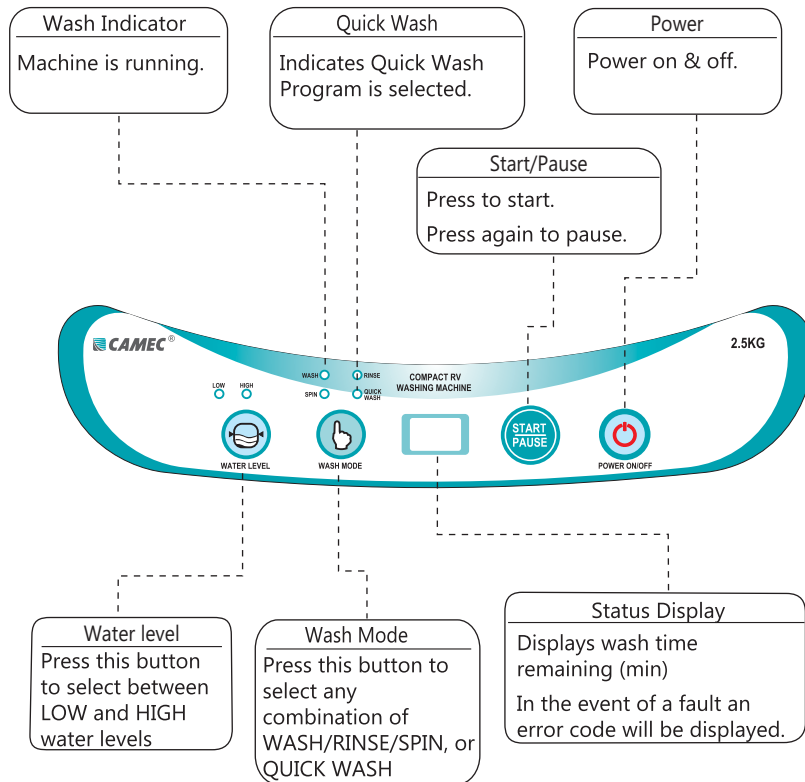

 To maximise washing machine life, please wait more than 30 seconds when switching the power on and off.

## CONTROL PANEL LAYOUT

### 3kg Model

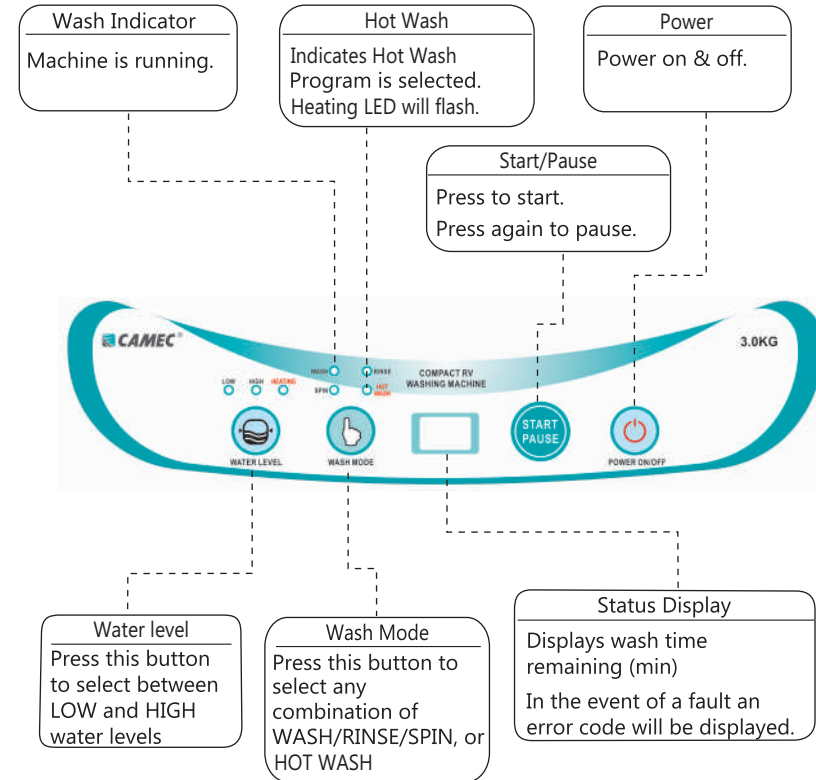

 To maximise washing machine life, please wait more than 30 seconds when switching the power on and off.